

PUBLIC NOTICE

Application of Sharyland Utilities, L.P. to Amend its Certificate of Convenience and Necessity for the Proposed Silverton to Cottonwood 345-kV CREZ Transmission Line in Briscoe, Crosby, Dickens, Floyd, and Motley Counties, Texas

PUBLIC UTILITY COMMISSION OF TEXAS (PUC) DOCKET NO. 38560

Sharyland Utilities, L.P. (“Sharyland”) provides this notice of intent to amend its Certificate of Convenience and Necessity (“CCN”) for the construction of a new 345 kilovolt (“kV”) transmission line to be located in Briscoe, Crosby, Dickens, Floyd, and Motley Counties. This project is one of several projects intended to allow for reliable and cost-effective delivery of power produced by renewable energy generators located in areas of West Texas and the Panhandle, called Competitive Renewable Energy Zones (“CREZ”), to load centers throughout the state. The Public Utility Commission of Texas (“PUC”) has assigned Docket No. 38560 to Sharyland’s application.

The estimated cost of Sharyland’s preferred route for the project is \$146,240,000. A map illustrating Sharyland’s preferred and alternate routes for the proposed project as well as written descriptions of these routes appears in this notice. A complete copy of the application filed at the PUC and a large scale map of the project area depicting the proposed preferred and alternate routes may be viewed at any of the following locations:

- | | |
|--|---|
| Briscoe County Courthouse
415 Main Street
Silverton, Texas 79257 | Floyd County Memorial Library
111 South Wall Street
Floydada, Texas 79235 |
| Dickens County Courthouse
512 Montgomery Street
Dickens, Texas 79229 | Motley County Courthouse
701 Dundee Avenue
Matador, Texas 79244 |

Persons with questions about the transmission line, or who would like to request a copy of the map appearing with this notice, may contact Sherry Kunka, Sharyland Utilities, L.P., toll free at (866) 354-3335 or by e-mail at suhelp@sharylandutilities.com. Persons who wish to intervene in the docket or comment on Sharyland’s application should mail the original and 10 copies of their requests to intervene or their comments to:

Public Utility Commission of Texas
Central Records
Attn: Filing Clerk
1701 N. Congress Avenue
P.O. Box 13326
Austin, Texas 78711-3326

Persons who wish to intervene in the docket must also mail a copy of their request for intervention to all parties in the docket and all persons that have pending motions to intervene, at or before the time the request for intervention is mailed to the PUC.

The deadline for intervention in the docket is October 8, 2010, and the PUC should receive a letter from anyone requesting intervention by that date.

The PUC has a brochure entitled “Landowners and Transmission Line Cases at the PUC for Competitive Renewable Energy Zone (CREZ) Projects.” Copies of the brochure are available from Sherry Kunka, Sharyland Utilities, L.P., toll free at (866) 354-3335, or by e-mail at suhelp@sharylandutilities.com, or may be downloaded from the PUC’s website at www.puc.state.tx.us. To obtain additional information about this docket, you may contact the PUC’s Customer Assistance Hotline at (512) 936-7120 or (888) 782-8477. Hearing- and speech-impaired individuals with text telephones (“TTY”) may contact the PUC’s Customer Assistance Hotline at (512) 936-7136 or toll free at (800) 735-2989. In addition to the intervention deadline, other important deadlines may already exist that affect your participation in this docket. You should review the orders and other filings already made in the docket. The PUC brochure explains how you can access these filings.

Silverton to Cottonwood Routes

PREFERRED ROUTE

Route 17: A4-A7-A-C-F-F'-G-L-P-U-U'-FF'-FF''-FF'''-OO-PP-MM1-MM2-MM3-MM4-QQ'''

ALTERNATE ROUTES (NOT LISTED IN ANY ORDER OF PRIORITY)

Route 1: A1-A5-A-B-B'-H-Y-Y'-CC-HH-JJ-LL-MM-TT-TT'	Route 10: A1-A5-A-D-D'-D''-J-R-W-B3-V'-EE-EE'-D1-D2-D3-D4-D5-D6-D7-TT'
Route 2: A4-A10-B'-H-T-W-B3-V'-EE-EE'-SS-SS'-SS''	Route 11: A4-A7-A8-A11-D'-D''-J-R-W-B3-V'-EE-C1-FF'''-RR-RR'-RR''-RR'''
Route 3: A4-A10-B'-E-F-F'-G-L-P-U-U'-FF'-FF''-FF'''-RR-RR'-RR''-RR'''	Route 12: A1-A2-A6-A11-D'-D''-F'-G-L-P-U-U'-GG-GG'-QQ-QQ'-QQ''-QQ'''
Route 4: A4-A7-A-C-I-Q-T-W-B3-V'-EE-EE'-SS-SS'-SS''	Route 13: A1-A2-A3-A12-A14-A16-G-K-S-X-X'-CC-HH-II-KK-MM-TT-TT'
Route 5: A1-A5-A-C-I-Q-Y-B1-B2-B3-B4-B5-B6-FF''-FF'''-OO-PP-TT-TT'	Route 14: A1-A2-A6-A9-A12-A14-A15-D''-F'-G-L-P-V-V'-DD-HH-II-KK-MM-MM1-MM2-MM3-MM4-QQ'''
Route 6: A1-A5-A-C-F-F'-G-L-P-U-U'-GG-GG'-NN-OO-PP-MM1-MM2-MM3-MM4-QQ'''	Route 15: A1-A5-A-D-A13-A14-A16-G-L-P-U-U'-GG-GG'-QQ-QQ'-QQ''-QQ'''
Route 7: A4-A7-A-C-F-F'-G-L-P-U-U'-FF'-FF''-FF'''-RR-RR'-RR''-RR'''	Route 16: A1-A5-A-C-I-Q-T-X-B2-B3-B4-U'-FF'-FF''-FF'''-OO-PP-MM1-MM2-MM3-MM4-QQ'''
Route 8: A4-A7-A-C-I-M-N-O-P-U-U'-GG-GG'-QQ-QQ'-QQ''-QQ'''	Route 17: A4-A7-A-C-F-F'-G-L-P-U-U'-FF'-FF''-FF'''-OO-PP-MM1-MM2-MM3-MM4-QQ'''
Route 9: A1-A2-A6-A11-D'-D''-F'-G-K-S-X-X'-CC-HH-JJ-LL-MM-MM1-SS'-SS''	

Silverton to Cottonwood Link Descriptions

Link A1

Link A1 begins at the proposed Silverton Station, located approximately 1 mile east of Farm-to-Market/ Ranch Road (FM/RR) 284 and 1.5 miles north of FM/RR 145 in Briscoe County. The link exits the station from the southeast corner and extends east for approximately 0.5 mile where it terminates at the junction of Links A2 and A5, located on the west side of County Road (CR) 10, approximately 1.5 miles north of FM/RR 145, 0.5 mile south of CR I, and 2 miles east of FM/RR 284 in Briscoe County.

Link A2

Link A2 begins at the junction of Links A1 and A5, located on the west side of CR 10, approximately 1.5 miles north of FM/RR 145 and 2 miles east of FM/RR 284 in Briscoe County. The link extends east for approximately 1 mile, where it terminates at the junction of Links A3 and A6, located on the west side of an existing 69-kilovolt (kV) transmission line approximately 1 mile west of State Highway (SH) 207, 1.5 miles north of FM/RR 145, and 0.5 mile south of CR I, in Briscoe County.

Link A3

Link A3 begins at the junction of Links A2 and A6, located on the west side of an existing 69-kV transmission line approximately 1 mile west of SH 207, 1.5 miles north of FM/RR 145, and 0.5 mile south of CR I in Briscoe County. The link extends southeast for approximately 1.1 miles to the west side of SH 207, where it turns south and parallels SH 207 for approximately 0.5 mile and terminates at the junction of Links A9 and A12, located on the west side of SH 207 approximately 0.5 mile north of FM/RR 145 in Briscoe County.

Link A4

Link A4 begins at the proposed Silverton Station, located approximately 1 mile east of FM/RR 284 and 1.5 miles north of FM/RR 145 in Briscoe County. The link exits the station from the southeast corner and extends south for approximately 1 mile as it crosses CR H, to where it terminates at the junction of Links A7 and A10, located approximately 0.5 mile north of FM/RR 145, and 1.5 miles east of FM/RR 284 in Briscoe County.

Link A5

Link A5 begins at the junction of Links A1 and A2, located on the west side of CR 10, approximately 1.5 miles north of FM/RR 145 and 2 miles east of FM/RR 284 in Briscoe County. The link extends south, parallel to and on the west side of CR 10, for approximately 1 mile, where it terminates at the junction of Links A, A7, and A8, located on the west side of CR 10 approximately 0.5 mile north of FM/RR 145 and 2 miles east of FM/RR 284 in Briscoe County.

Link A6

Link A6 begins at the junction of Links A2 and A3, located on the west side of an existing 69-kV transmission line approximately 1 mile west of SH 207, 1.5 miles north of FM/RR 145, and 0.5 mile south of CR I in Briscoe County. The link extends south, parallel to and on the west side of the existing 69-kV transmission line, for approximately 1 mile, where it terminates at the junction of Links A8, A9 and A11, located on the west side of the existing 69-kV transmission line approximately 0.5 mile north of FM/RR 145 and 1 mile west of SH 207 in Briscoe County.

Link A7

Link A7 begins at the junction of Links A4 and A10, located approximately 0.5 mile north of FM/RR 145, and 1.5 miles east of FM/RR 284 in Briscoe County. It extends east for approximately 0.5 mile where it terminates at the junction of Links A, A5, and A8, located on the west side of CR 10, approximately 0.5 mile north of FM/RR 145 and 2 miles east of FM/RR 284 in Briscoe County.

Link A8

Link A8 begins at the junction of Links A, A5, and A7, located on the west side of CR 10 approximately 0.5 mile north of FM/RR 145 and 2 miles east of FM/RR 284 in Briscoe County. It extends east for approximately 1 mile, where it terminates at the junction of Links A6, A9, and A11, located on the west side of an existing 69-kV transmission line approximately 0.5 mile north of FM/RR 145 and 1 mile west of SH 207 in Briscoe County.

Link A9

Link A9 begins at the junction of Links A6, A8, and A11, located on the west side of an existing 69-kV transmission line approximately 0.5 mile north of FM/RR 145 and 1 mile west of SH 207 in Briscoe County. It extends east for approximately 0.9 mile where it terminates at the junction of Links A3 and A12 located on the west side of SH 207 approximately 0.5 mile north of FM/RR 145 in Briscoe County.

Link A10

Link A10 begins at the junction of Links A4 and A7, located approximately 0.5 mile north of FM/RR 145, and 1.5 miles east of FM/RR 284 in Briscoe County. It extends southwest for approximately 0.7 mile, where it crosses the intersection of FM/RR 145 and CR 9, and continues southwest for approximately 0.8 mile. It then angles south-southwest for approximately 0.6 mile as it crosses CR F and terminates at the junction of Links B and B', located on the south side of CR F approximately 0.2 mile east of FM/RR 284 and 1 mile south of FM/RR 145 in Briscoe County.

Link A11

Link A11 begins at the junction of Links A6, A8, and A9, located on the west side of an existing 69-kV transmission line approximately 0.5 mile north of FM/RR 145 and 1 mile west of SH 207 in Briscoe County. It extends south, parallel to and on the west side of the existing 69-kV transmission line for approximately 0.5 mile before it crosses FM/RR 145. After crossing FM/RR 145, it continues parallel to and on the west side of the existing 69-kV transmission line for approximately 0.1 mile, angles slightly east and extends south-southeast approximately 0.3 mile as it crosses the existing 69-kV transmission line. Link A11 then continues south, parallel to and on the east side of the existing 69-kV transmission line for approximately 0.6 mile where it terminates at the junction of Links A13, D, and D', located on the east side of the existing 69-kV transmission line and the north side of CR F, approximately 1 mile west of SH 207 in Briscoe County.

Link A12

Link A12 begins at the junction of Links A3 and A9, located on the west side of SH 207 approximately 0.5 mile north of FM/RR 145 in Briscoe County. It extends south parallel to and on the west side of SH 207 for approximately 1.5 miles as it crosses FM/RR 145, an existing 69-kV transmission line, and an abandoned railroad grade, before terminating at the junction of Links A13 and A14, located on the northwest side of the intersection of SH 207 and CR F, approximately 1 mile south of FM/RR 145 in Briscoe County.

Link A13

Link A13 begins at the junction of Links A11, D, and D', located on the east side of an existing 69-kV transmission line and the north side of CR F, approximately 1 mile west of SH 207 in Briscoe County. It extends east parallel to and on the north side of CR F for approximately 1 mile as it crosses an abandoned railroad grade, where it terminates at the junction of Links A12 and A14, located on the northwest side of the intersection of SH 207 and CR F, approximately 1 mile south of FM/RR 145 in Briscoe County.

Link A14

Link A14 begins at the junction of Links A12 and A13, located on the northwest side of the intersection of SH 207 and CR F, approximately 1 mile south of FM/RR 145 in Briscoe County. It extends south, parallel to and on the west side of SH 207, for approximately 1.7 miles, then crosses to the east side of SH 207 for approximately 0.9 mile, and crosses back to the west side of SH 207 for approximately 2.9 miles, where it then crosses into Floyd County. After crossing into Floyd County, it continues parallel to and on the west side of SH 207 for another 0.6 mile, where it terminates at the junction of Links A15 and A16, located on the northwest side of the intersection of CR 30 and SH 207, approximately 0.5 mile south of the Briscoe/Floyd county line in Floyd County.

Link A15

Link A15 begins at the junction of Links D' and D'', located on the north side of CR 30, and the east side of an existing 69-kV transmission line, approximately 0.5 mile south of the Briscoe/Floyd county line in Floyd County. It extends east parallel to and on the north side of CR 30 for approximately 0.9 mile to where it terminates at the junction of Links A14 and A16, located on the northwest side of the intersection of CR 30 and SH 207, approximately 0.5 mile south of the Briscoe/Floyd county line in Floyd County.

Link A16

Link A16 begins at the junction of Links A14 and A15, located on the northwest side of the intersection of CR 30 and SH 207, approximately 0.5 mile south of the Briscoe/Floyd county line in Floyd County. It crosses CR 30 and extends south, parallel to and on the west side of SH 207, for approximately 1.3 miles, before angling across SH 207 to run parallel to and on the east side of SH 207 for approximately 1.8 miles. It then crosses again to the west side of SH 207 for approximately 0.3 mile to just south of FM/RR 689, and then crosses again to the east side of SH 207 for approximately 0.6 mile, crosses an existing 69-kV transmission line, and continues another 0.8 mile crossing Quitaque Creek. The link then crosses SH 207 as it extends south-southwest for approximately 0.3 mile, where it crosses an abandoned railroad grade. The link then heads south for approximately 0.2 mile before reverting back to the southwest for approximately 0.3 mile, then south again for approximately 0.1 mile, and then southeast for approximately 0.3 mile. It then again runs parallel to and on the west side of SH 207 for approximately 0.2 mile where it crosses FM/RR 2286 and continues another 0.9 mile where it terminates at the junction of Links F' and G, located on the west side of SH 207, approximately 0.9 mile south of FM/RR 2286 in Floyd County.

Link A

Link A begins at the junction of Links A5, A7, and A8, located on the west side of CR 10 approximately 0.5 mile north of FM/RR 145 and 2 miles east of FM/RR 284 in Briscoe County. It extends south, parallel to and on the west side of CR 10 for approximately 0.5 mile before crossing FM/RR 145. The link continues south approximately 1 mile where it terminates at the junction of Links B, C, and D, located on the northwest side of the intersection of CR F and CR 10, approximately 2 miles west of SH 207 in Briscoe County.

Link B

Link B begins at the junction of Links A10 and B', located on the south side of CR F approximately 0.2 mile east of FM/RR 284 and 1 mile south of FM/RR 145 in Briscoe County. It extends east, parallel to and on the south side of CR F, for approximately 1.5 miles. The link then crosses to the north side of CR F just before it terminates at the junction of Links A, C, and D, located on the northwest side of the intersection of CR F and CR 10, approximately 2 miles west of SH 207 in Briscoe County.

Link B'

Link B' begins at the junction of Links A10 and B, located on the south side of CR F approximately 0.2 mile east of FM/RR 284 and 1 mile south of FM/RR 145 in Briscoe County. It extends southwest for approximately 0.4 mile, crossing FM/RR 284, then turns south and extends parallel to and on the west side of FM/RR 284 for approximately 0.4 mile. It then turns southeast for approximately 0.1 mile, crossing to the east side of FM/RR 284. It then extends south, parallel to and on the east side of FM/RR 284, for approximately 2.3 miles to where FM/RR 284 ends at CR C and becomes CR 8. The link continues south, parallel to and on the east side of CR 8, for approximately 2.4 miles, crossing from Briscoe County into Floyd County (where CR 8 ends and becomes CR 129). It then continues for another 3.7 miles, crosses CR 30, CR 50, and Quitaque Creek, to where it crosses to the west side of CR 129 again for approximately 0.1 mile, and extends south another 0.3 mile to cross an abandoned railroad grade. The link continues south for 0.7 mile, where it crosses an existing 69-kV transmission line, before extending another 1 mile to where it terminates at the junction of Links E and H, located on the west side of CR 129, approximately 0.9 mile north of FM/RR 2286 in Floyd County.

Link C

Link C begins at the junction of Links A, B, and D, located on the northwest side of the intersection of CR F and CR 10, approximately 2 miles west of SH 207 in Briscoe County. It crosses CR F as it extends south, parallel to and on the west side of CR 10, for approximately 1 mile to where CR 10 ends, and then continues south for another 3.9 miles (crossing CR D and CR C) to where it crosses an abandoned railroad grade and CR A, before continuing 1 mile to the Briscoe/Floyd County line. From the Briscoe/Floyd County Line, it continues south, parallel to and on the west side of CR 149, for approximately 0.4 mile, then crosses to the east side of CR 149 at CR 30, and continues south, parallel to CR 149, for approximately 5.2 miles, crossing Quitaque Creek and an existing 69-kV transmission line. The link then crosses CR 80 and terminates at the junction of Links E, F, and I, located on the southeast side of the intersection of CR 80 and CR 149, approximately 0.9 mile north of FM/RR 2286 in Floyd County.

Link D

Link D begins at the junction of Links A, B, and C, located on the northwest side of the intersection of CR F and CR 10, approximately 2 miles west of SH 207 in Briscoe County. The link extends east approximately 1 mile as it crosses CR 10 and continues parallel to and on the north side of CR F, crossing an existing 69-kV transmission line and terminating at the junction of Links A11, A13, and D', located on the east side of an existing 69-kV transmission line and on the north side of CR F, approximately 1 mile west of SH 207 in Briscoe County.

Link D'

Link D' begins at the junction of Links A11, A13, and D, located on the east side of an existing 69-kV transmission line and on the north side of CR F, approximately 1 mile west of SH 207 in Briscoe County. It extends south, parallel to and on the east side of an existing 69-kV transmission line for approximately 5.5 miles to the Briscoe/Floyd county line as it crosses CR F, CR 11, CR E, CR D, an abandoned railroad grade, CR C, and CR A. It then continues south into Floyd County, parallel to and on the east side of the existing 69-kV transmission line, for approximately 0.5 mile where it terminates at the junction of Links A15 and D'', located on the north side of CR 30 and the east side of the existing 69-kV transmission line, approximately 0.5 mile south of the Briscoe/Floyd county line in Floyd County.

Link D''

Link D'' begins at the junction of Links A15 and D', located on the north side of CR 30 and the east side of an existing 69-kV transmission line, approximately 0.5 mile south of the Briscoe/Floyd county line in Floyd County. It crosses CR 30 as it extends south, parallel to and on the east side of the existing 69-kV transmission line, for approximately 4.2 miles to where it crosses Quitaque Creek, CR 72, and another 69-kV transmission line. After crossing CR 72, Link D'' continues south, parallel to and on the east side of CR 159 for approximately 1 mile, then angles south-southwest as it crosses CR 80. After crossing CR 80, it extends approximately 0.2 mile before crossing to the west side of CR 159. It then continues south, parallel to and on the west side of CR 159 for approximately 0.3 mile and angles south again. The link heads south approximately 0.1 mile, crosses an abandoned railroad grade, then proceeds approximately 0.3 mile to where it terminates at the junction of Links F, F', and J, located on the northwest side of the intersection of FM/RR 2286 and CR 159, approximately 1 mile west of SH 207 in Floyd County.

Link E

Link E begins at the junction of Links B' and H, located on the west side of CR 129, approximately 0.9 mile north of FM/RR 2286 in Floyd County. It crosses CR 129 and extends east for approximately 2 miles before crossing CR 149 to where it terminates at the junction of Links C, F, and I, located on the southeast side of the intersection of CR 80 and CR 149, approximately 0.9 mile north of FM/RR 2286 in Floyd County.

Link F

Link F begins at the junction of Links C, E, and I, located on the southeast side of the intersection of CR 80 and CR 149, approximately 0.9 mile north of FM/RR 2286 in Floyd County. It extends southeast for approximately 1 mile where it terminates at the junction of Links D'', F', and J, located on the northwest side of the intersection of FM/RR 2286 and CR 159, approximately 1 mile west of SH 207 in Floyd County.

Link F'

Link F' begins at the junction of Links D'', F, and J, located on the northwest side of the intersection of FM/RR 2286 and CR 159, approximately 1 mile west of SH 207 in Floyd County. It extends southeast, crosses CR 159 and FM/RR 2286, and continues for approximately 0.9 mile, then adjusts very slightly to the south for approximately 0.4 mile to where it terminates at the junction of Links A16 and G, located on the west side of SH 207 approximately 0.9 mile south of FM/RR 2286 in Floyd County.

Link G

Link G begins at the junction of Links A16 and F', located on the west side of SH 207 approximately 0.9 mile south of FM/RR 2286 in Floyd County. It extends southeast, crosses SH 207 and continues approximately 1.5 miles, where it crosses an existing 69-kV transmission line and terminates at the junction of Links K and L, located on the south side of the existing 69-kV transmission line, approximately 0.9 mile east of SH 207, and 2 miles south of FM/RR 2286.

Link H

Link H begins at the junction of Links B' and E, located on the west side of CR 129 approximately 0.9 mile north of FM/RR 2286 in Floyd County. The link extends south, parallel to and on the west side of CR 129, for approximately 0.9 mile, crosses FM/RR 2286, and extends approximately 0.2 mile, where it crosses an abandoned railroad grade and CR 92. Link H then continues south but ceases to parallel CR 129 for 0.4 mile as CR 129 deviates from a straight path to the south. Link H then crosses CR 129 as CR 129 returns to its original path to the south and Link H begins to run parallel to and on the west side of CR 129 again for approximately 1.4 mile to CR 110 and an existing 69-kV transmission line. Link H crosses CR 110 and the existing 69-kV transmission line and continues south, parallel to and on the west side of CR 129, for approximately another 1 mile to CR 120. The link then crosses CR 120, and immediately angles southeast to cross CR 129. After crossing CR 129, Link H extends southeast for approximately 0.4 mile, then heads south-southeast for approximately 8.4 miles as it crosses CR 140, FM/RR 97, CR 162, CR 141, CR 180, and FM/RR 786, to where it terminates at the junction of Links Q, T, and Y, located on the southwest side of the intersection of CR 149 and CR 202, 1 mile west of SH 207 in Floyd County.

Link I

Link I begins at the junction of Links C, E, and F, located on the southeast side of the intersection of CR 80 and CR 149, approximately 0.9 mile north of FM/RR 2286 in Floyd County. The link extends south, parallel to and on the east side of CR 149 for approximately 6.5 miles (as it crosses an abandoned railroad grade, FM/RR 2286, CR 100, an existing 69-kV transmission line, CR 110, CR 120, and CR 140) to where it terminates at the junction of Links M and Q, located on the east side of CR 149, approximately 0.5 mile south of CR 140, and 0.6 mile north of FM/RR 97 in Floyd County.

Link J

Link J begins at the junction of Links D'', F, and F', located on the northwest side of the intersection of FM/RR 2286 and CR 159, approximately 1 mile west of SH 207 in Floyd County. It extends south, parallel to and on the west side of CR 159, and crosses FM/RR 2286. It then continues south for approximately 3 miles as it crosses CR 100, an existing 69-kV transmission line, and CR 110, to where it angles south-southeast. The link then heads south-southeast for approximately 0.1 mile, crosses CR 120 (where CR 159 ends), continues south-southeast for

approximately 2 miles, crosses CR 140, and continues approximately 0.5 mile to where it terminates at the junction of Links M, N, and R, located approximately 0.7 mile north of FM/RR 97 and 0.5 mile west of SH 207 in Floyd County.

Link K

Link K begins at the junction of Links G and L, located on the south side of an existing 69-kV transmission line, approximately 0.9 mile east of SH 207, and 2 miles south of FM/RR 2286 in Floyd County. The link extends south for approximately 3.5 miles as it crosses CR 120, CR 130, and FM/RR 97 to where it terminates at the junction of Links N, O, and S, located approximately 1 mile east of SH 207 and 0.5 mile south of FM/RR 97 in Floyd County.

Link L

Link L begins at the junction of Links G and K, located on the south side of an existing 69-kV transmission line, approximately 0.9 mile east of SH 207, and 2 miles south of FM/RR 2286 in Floyd County. The link extends southeast for approximately 4.5 miles as it crosses CR 120, CR 189, CR 130, and FM/RR 97 to where it terminates at the junction of Links O and P, located on the west side of CR 211, 0.5 mile south of FM/RR 97 in Floyd County.

Link M

Link M begins at the junction of Links I and Q, located on the east side of CR 149, approximately 0.5 mile south of CR 140, and 0.6 mile north of FM/RR 97 in Floyd County. Link M extends east for approximately 1.5 miles to where it terminates at the junction of Links J, N, and R, located approximately 0.7 mile north of FM/RR 97 and 0.5 mile west of SH 207 in Floyd County.

Link N

Link N begins at the junction of Links J, M, and R, located approximately 0.7 mile north of FM/RR 97 and 0.5 mile west of SH 207 in Floyd County. It extends east for approximately 1.5 miles (crossing SH 207), to where it terminates at the junction of Links K, O, and S, located approximately 1 mile east of SH 207 and 0.5 mile south of FM/RR 97 in Floyd County.

Link O

Link O begins at the junction of Links K, N, and S, located approximately 1 mile east of SH 207 and 0.5 mile south of FM/RR 97 in Floyd County. The link extends east for approximately 2.9 miles as it crosses CR 189 and CR 201 to where it terminates at the junction of Links L and P, located on the west side of CR 211, 0.5 mile south of FM/RR 97 in Floyd County .

Link P

Link P begins at the junction of Links L and O, located on the west side of CR 211, 0.5 mile south of FM/RR 97 in Floyd County. Link P extends southeast for approximately 1.7 miles as it crosses CR 211 and CR 150 to where it terminates at the junction of Links U and V, located approximately 0.2 mile north-northeast of the intersection of CR 160 and CR 221 in Floyd County.

Link Q

Link Q begins at the junction of Links I and M, located on the east side of CR 149, approximately 0.5 mile south of CR 140, and 0.6 mile north of FM/RR 97 in Floyd County. It extends south for approximately 0.6 mile (crossing FM/RR 97), then adjusts slightly southeast for approximately 0.9 mile crossing CR 149, then back slightly to the southwest for approximately 0.2 mile (crossing back to the west side of CR 149), and then heads south parallel to and on the west side of CR 149 for approximately 0.9 mile, where it crosses a bend in CR 149, and continues another 2.3 miles, crossing CR 180 and recrossing CR 149 to run parallel to and on the west side of CR 149, and then crossing FM/RR 786. It then extends another 1.1 miles to where it terminates at the junction of Links H, T, and Y, located on the southwest side of the intersection of CR 149 and CR 202, 1 mile west of SH 207 in Floyd County.

Link R

Link R begins at the junction of Links J, M, and N, located approximately 0.7 mile north of FM/RR 97 and 0.5 mile west of SH 207 in Floyd County. The link extends south-southeast approximately 0.7 mile, crosses FM/RR 97, extends approximately 1.6 miles then angles generally east for approximately 0.2 mile, crosses SH 207, and continues approximately another 0.1 mile to where it angles more to the south. The link then heads south approximately 1.2 miles, crosses CR 180, and then extends southeast approximately 0.8 mile before angling south-southeast again. It then heads south-southeast for approximately 0.5 mile, crosses CR 192, proceeds approximately 1.2 miles, crosses FM/RR 786, and then terminates at the junction of Links S, T, X, and W, located on the southwest side of the intersection of FM/RR 786 and CR 181 in Floyd County.

Link S

Link S begins at the junction of Links K, N and O, located approximately 1 mile east of SH 207 and 0.5 mile south of FM/RR 97 in Floyd County. Link S extends south approximately 0.5 mile, crosses CR 150, extends approximately 1 mile, and crosses CR 160. It then proceeds south approximately 1 mile, crosses CR 170, and then begins to extend parallel to and on the east side of CR 179. It continues south approximately 0.8 mile where it angles south-southeast and away from CR 179. The link extends south-southeast approximately 0.4 mile, and then heads south, parallel to and on the west side of CR 181, for approximately 1 mile where it crosses CR 192. Link S then continues south approximately 1.1 miles, crosses FM/RR 786, then heads west, parallel to and on the south side of FM/RR 786 for approximately 0.2 mile before terminating at the junction of Links R, T, W, and X, located on the southwest side of the intersection of FM/RR 786 and CR 181 in Floyd County.

Link T

Link T begins at the junction of Links H, Q, and Y, located on the southwest side of the intersection of CR 149 and CR 202, 1 mile west of SH 207 in Floyd County. It extends east, parallel to and on the south side of CR 202, for approximately 0.9 mile before crossing SH 207, where CR 202 becomes FM/RR 786. The link then continues east parallel to and on the south side of FM/RR 786 for approximately 1 mile, crosses CR 171 and continues approximately 1 mile where it terminates at the junction of Links R, S, W, and X, located on the southwest side of the intersection of FM/RR 786 and CR 181 in Floyd County.

Link U

Link U begins at the junction of Links P and V, located approximately 0.2 mile north-northeast of the intersection of CR 160 and CR 221 in Floyd County. The link extends south-southeast for approximately 0.3 mile, crosses CR 160, extends approximately 2.6 miles and crosses CR 178, then continues approximately 1.3 miles before crossing CR 190. It continues south-southeast approximately 0.9 mile, crosses CR 251, extends approximately 0.4 mile to cross CR 200, proceeds approximately 1.5 miles, and then heads southeast approximately 1.1 miles before angling south-southeast again. It then extends south-southeast approximately 1.6 miles, crosses CR 283, and continues approximately 0.2 mile to where it terminates at the junction of Links B4, B5, and U', located approximately 1.9 miles west of FM/RR 28, northeast of the intersection of CR 232 and CR 283 in Floyd County.

Link U'

Link U' begins at the junction of Links U, B4, and B5, located approximately 1.9 miles west of FM/RR 28, northeast of the intersection of CR 232 and CR 283 in Floyd County. It proceeds southeast, crosses CR 232, and continues for approximately 1.9 miles to where it terminates at the junction of Links FF' and GG, located approximately 0.6 mile north of US 62/70 and 0.7 mile west of FM/RR 28 in Floyd County.

Link V

Link V begins at the junction of Links P and U, located approximately 0.2 mile north-northeast of the intersection of CR 160 and CR 221 in Floyd County. Link V extends south, parallel to and on the west side of CR 221 for approximately 0.2 mile, crosses CR 160, proceeds approximately 2 miles, crosses CR 178, continues approximately 0.8 mile, and then angles south-southeast. The link extends south-southeast approximately 0.2 mile and crosses to the east side of CR 221, continues approximately 200 ft, and then heads southwest approximately 200 ft before crossing CR 190. It continues southwest approximately 200 ft, crosses to the west side of FM/RR 786, extends approximately 0.4 mile, heads south, parallel to and on the west side of FM/RR 786, for approximately 0.8 mile and then crosses FM/RR 786 where FM/RR 786 veers southwest. The link then begins to extend parallel to and on the west side of FM/RR 602. Link V then proceeds south approximately 2.1 miles, crosses CR 220, and continues approximately 1 mile to where it terminates at the junction of Links B3, B4 and V', located on the northwest side of the intersection of FM/RR 602 and CR 232, approximately 2 miles north of US 62/70 and 6 miles east of SH 207 in Floyd County.

Link V'

Link V' begins at the junction of Links B3, B4, and V, located on the northwest side of the intersection of FM/RR 602 and CR 232, approximately 2 miles north of US 62/70 and 6 miles east of SH 207 in Floyd County. It extends south, immediately crossing CR 232, and then angles south-southeast. The link heads south-southeast approximately 0.1 mile, crosses to the east side of FM/RR 602, and then heads south again, parallel to and on the east side of FM/RR 602 for approximately 0.9 mile, where it terminates at the junction of Links DD and EE,

located on the southeast side of the intersection of FM/RR 602 and CR 242, approximately 1 mile north of US 62/70, and 6.1 miles east of SH 207 in Floyd County.

Link W

Link W begins at the junction of Links R, S, T, and X, located on the southwest side of the intersection of FM/RR 786 and CR 181 in Floyd County. It extends southeast for approximately 3.8 miles, crossing CR 191 and CR 220, to where it terminates at the junction of Links B2 and B3, approximately 0.1 mile northwest of the intersection of FM/RR 651 and CR 232 in Floyd County.

Link X

Link X begins at the junction of Links R, S, T and W, located on the southwest side of the intersection of FM/RR 786 and CR 181 in Floyd County. The link extends south for approximately 3 miles, parallel to and on the west side of CR 181, to where it terminates at the junction of Links B1, B2, and X', located on the northwest side of the intersection of CR 181 and CR 232, 2 miles east of SH 207 and 2 miles north of US 62/70 in Floyd County.

Link X'

Link X' begins at the junction of Links B1, B2, and X, located on the northwest side of the intersection of CR 181 and CR 232, 2 miles east of SH 207, and 2 miles north of US 62/70. It extends south for approximately 1 mile, where it crosses CR 242 and terminates at the junction of Links CC and Y', located on the southwest side of the intersection of CR 242 and CR 181, approximately 2 miles east of FM/RR 207 and 1 mile north of US 62/70 in Floyd County.

Link Y

Link Y begins at the junction of Links H, Q, and T, located on the southwest side of the intersection of CR 149 and CR 202, approximately 1 mile west of SH 207 in Floyd County. It extends southeast for approximately 1.2 miles, crosses CR 212, extends another 0.2 mile before crossing SH 207, and then continues for approximately 0.3 mile, where it adjusts slightly more east (but still heading southeast) for approximately 0.5 mile. It then angles more to the south and heads south-southeast for approximately 0.8 mile, crosses CR 171 and continues approximately 0.7 mile, where it terminates at the junction of Links B1 and Y', located on the north side of CR 232, approximately 1.3 miles east of SH 207 and 2 miles north of US 62/70 in Floyd County.

Link Y'

Link Y' begins at the junction of Links B1 and Y, located on the north side of CR 232, approximately 1.3 miles east of SH 207 and 2 miles north of US 62/70 in Floyd County. It extends south-southeast immediately crossing CR 232 and continues for approximately 1.2 miles where it crosses CR 242. After crossing CR 242, Link Y' terminates at the junction of Links CC and X', located on the southwest side of the intersection of CR 242 and CR 181, approximately 2 miles east of FM/RR 207, and 1 mile north of US 62/70 in Floyd County.

Link B1

Link B1 begins at the junction of Links Y and Y', located on the north side of CR 232, approximately 1.3 miles east of SH 207 and 2 miles north of US 62/70 in Floyd County. It extends east for approximately 0.6 mile, parallel to and on the north side of CR 232, where it terminates at the junction of Links B2, X and X', located northwest of the intersection of CR 181 and CR 232, approximately 2 miles east of SH 207 and 2 miles north of US 62/70 in Floyd County.

Link B2

Link B2 begins at the junction of Links B1, X, and X', located northwest of the intersection of CR 181 and CR 232, approximately 2 miles east of SH 207, and 2 miles north of US 62/70 in Floyd County. The link immediately crosses CR 181 and continues east parallel to and on the north side of CR 232 for approximately 1 mile and crosses CR 191. It then continues east parallel to and on the north side of CR 232 approximately 1 mile, where it terminates at the junction of Links B3 and W, located approximately 0.1 mile northwest of the intersection of FM/RR 651 and CR 232 in Floyd County.

Link B3

Link B3 begins at the junction of Links B2 and W, located approximately 0.1 mile northwest of the intersection of FM/RR 651 and CR 232 in Floyd County. It extends east, parallel to and on the north side of CR 232 for approximately 2 miles (crosses CR 211) where it terminates at the junction of Links B4, V, and V', located on the northwest side of the intersection of FM/RR 602 and CR 232, approximately 2 miles north of US 62/70 and 6 miles east of SH 207 in Floyd County.

Link B4

Link B4 begins at the junction of Links B3, V and V', located on the northwest side of the intersection of FM/RR 602 and CR 232, approximately 2 miles north of US 62/70 and 6 miles east of SH 207 in Floyd County. It crosses FM/RR 602 and extends east parallel to and on the north side of CR 232 for 1 mile, crosses CR 231, and then proceeds approximately 1 mile before crossing CR 241. The link continues east approximately 1 mile, crosses CR 251, extends approximately 3 miles, crosses CR 283, and continues approximately 0.1 mile where it terminates at the junction of Links B5, U, and U', located approximately 1.9 miles west of FM/RR 28, northeast of the intersection of CR 232 and CR 283 in Floyd County.

Link B5

Link B5 begins at the junction of Links B4, U, and U' located approximately 1.9 miles west of FM/RR 28, northeast of the intersection of CR 232 and CR 283 in Floyd County. It extends east, parallel to and on the north side of CR 232 for approximately 1.9 miles where it crosses FM/RR 28 and turns south, extending parallel to and on the east side of FM/RR 28 for approximately 1.5 miles to where it terminates at the junction of Links B6, GG, and GG', located on the east side of FM/RR 28, 0.6 mile north of US 62/70 in Floyd County.

Link B6

Link B6 begins at the junction of Links B5, GG, and GG', located on the east side of FM/RR 28, 0.6 mile north of US 62/70 in Floyd County. It extends south, parallel to and on the east side of FM/RR 28, for approximately 0.6 mile to where it crosses US 62/70. FM/RR 28 then turns into CR 303 and the link extends parallel to and on the east side of CR 303 for 0.3 mile to where it terminates at the junction of Links FF' and FF'', located on the east side of CR 303, approximately 0.3 mile south of US 62/70 in Floyd County.

Link C1

Link C1 begins at the junction of Links EE and EE', located on the northeast side of an abandoned railroad grade approximately 1 mile south of US 62/70 and 2.8 miles east of FM/RR 602 in Floyd County. It extends east for approximately 1.2 miles to where it crosses CR 271. It then continues east, parallel to and on the north side of CR 260 for approximately 1 mile to where it crosses CR 283. It continues approximately 1 mile to the east, parallel to and on the north side of CR 260, before angling east-northeast as it crosses FM/RR 28. After crossing FM/RR 28, it heads east again, parallel to and on the north side of CR 260, for approximately 1 mile to where it angles southeast and crosses CR 303. It then angles southeast and heads east again for approximately 0.6 mile (parallel to and on the north side of CR 260) to where it terminates at the junction of Links FF'' and FF''', located on the north side of CR 260, 0.5 mile east of CR 303 in Floyd County.

Link CC

Link CC begins at the junction of Links X' and Y', located on the southwest side of the intersection of CR 242 and CR 181, approximately 2 miles east of FM/RR 207 and 1 mile north of US 62/70 in Floyd County. The link extends southeast for approximately 1.3 miles, crosses CR 191, extends approximately 0.4 mile, angles more south (but still heads southeast) for approximately 0.1 mile, crosses US 62/70 and continues approximately 0.4 mile before crossing an abandoned railroad grade. It then proceeds southeast approximately 0.5 mile where it crosses an existing 69-kV transmission line and FM/RR 651, extends approximately 1.4 miles and then crosses CR 211. It then continues approximately 0.6 mile before crossing another existing 69-kV transmission line. The link then crosses CR 270, and extends another 0.7 mile to where it terminates at the junction of Links DD and HH, located on the west side of CR 221, 1 mile west of FM/RR 602 and 2.5 miles south of US 62/70 in Floyd County.

Link DD

Link DD begins at the junction of Links EE and V', located on the southeast side of the intersection of FM/RR 602 and CR 242, 1 mile north of US 62/70 and 6.1 miles east of SH 207 in Floyd County. It extends south, parallel to and on the east side of FM/RR 602, for approximately 0.5 mile, and then crosses to the west side of FM/RR 602 for approximately 0.2 mile. The link then continues south, parallel to and on the west side of FM/RR 602, for approximately 0.3 mile and crosses the point where US 62/70 and FM/RR 602 intersect. The link continues approximately 0.2 mile where it crosses an abandoned railroad grade. It then extends approximately 1.7 miles south, crosses an existing 69-kV transmission line and CR 270, and then extends, parallel to and on the west side of CR 221, for approximately another 0.5 mile to where it terminates at the

junction of Links CC and HH, located on the west side of CR 221, 1 mile west of FM/RR 602 and 2.5 miles south of US 62/70 in Floyd County.

Link D1

Link D1 begins at the junction of Links EE', OO, and PP, located on the south side of FM/RR 684, approximately 1 mile east of FM/RR 28 and 0.3 mile west of the Floyd/Motley county line, in Floyd County. It extends east, parallel to and on the south side of FM/RR 684 for approximately 0.3 mile to the Floyd/Motley county line, and then continues, parallel to and on the south side of FM/RR 684, into Motley County for approximately 1.7 miles. The link then adjusts slightly southeast with FM/RR 684 for approximately 0.3 mile before turning east again, parallel to and on the south side of FM/RR 684 for approximately 0.3 mile where it terminates at the junction of Links D2, RR, and RR', located on the south side of FM/RR 684, approximately 2.2 miles east of the Floyd/Motley county line in Motley County.

Link D2

Link D2 begins at the junction of Links D1, RR, and RR', located on the south side of FM/RR 684 in Motley County, approximately 2.2 miles east of the Floyd/Motley county line. It extends southeast for approximately 0.7 mile where it crosses an abandoned railroad grade and then continues to extend southeast for another 2.1 miles, running parallel but not immediately adjacent to the abandoned railroad grade. Link D2 then continues to extend southeast for 0.4 mile, but ceases to parallel the abandoned railroad grade as the abandoned railroad grade turns east. After the abandoned railroad grade turns back southeast, Link D2 begins to parallel the abandoned railroad grade again and run adjacent to the northeast side of the abandoned railroad grade for approximately 0.4 mile where it terminates at the junction of Links D3, QQ, and QQ', located on the northeast side of the abandoned railroad grade, approximately 1.3 miles south of FM/RR 684 and 1.5 miles west of CR 316 in Motley County.

Link D3

Link D3 begins at the junction of Links D2, QQ, and QQ', located on the northeast side of an abandoned railroad grade, approximately 1.3 miles south of FM/RR 684 and 1.5 miles west of CR 316 in Motley County. It extends southeast, parallel to and on the northeast side of the abandoned railroad grade for approximately 1.6 miles where it turns to the south, crossing the abandoned railroad grade, and then continues south for approximately 1.5 miles to where it terminates at the junction of links D4, QQ' and QQ'', located approximately 3.7 miles west of SH 70 and 1.5 miles north of the Motley/Dickens county line in Motley County.

Link D4

Link D4 begins at the junction of Links D3, QQ', and QQ'', located approximately 3.7 miles west of SH 70 and 1.5 miles north of the Motley/Dickens county line. It extends south for approximately 1.4 miles as it crosses the Tongue River, where it terminates at the junction of Links D5, MM3 and MM4, located approximately 0.5 mile north of the Motley/Dickens county line, 4 miles west of SH 70, and 4.6 miles south of FM/RR 684 in Motley County.

Link D5

Link D5 begins at the junction of Links D4, MM3, and MM4, located approximately 0.5 mile north of the Motley/Dickens county line, 4 miles west of SH 70, and 4.6 miles south of FM/RR 684 in Motley County. It extends south for approximately 1.4 miles as it crosses the Motley/Dickens county line and Grapevine Creek to where it terminates at the junction of Links D6, RR'' and RR''', located approximately 3.5 miles north of FM/RR 193, and 4 miles west of SH 70 in Dickens County.

Link D6

Link D6 begins at the junction of Links D5, RR'' and RR''', located approximately 3.5 miles north of FM/RR 193 and 4 miles west of SH 70 in Dickens County. It extends south for approximately 2.5 miles to where it terminates at the junction of Links D7, SS', and SS'', located approximately 0.5 mile west of CR 121 and 1 mile north of FM/RR 193 in Dickens County.

Link D7

Link D7 begins at the junction of Links D6, SS' and SS'', located approximately 0.5 mile west of CR 121 and 1 mile north of FM/RR 193 in Dickens County. It extends south for approximately 0.5 mile, terminating at the junction of Links TT and TT', located approximately 0.5 mile north of FM/RR 193 and 0.5 mile west of CR 121 in Dickens County.

Link EE

Link EE begins at the junction of Links DD and V', located on the southeast side of the intersection of FM/RR 602 and CR 242, located approximately 1 mile north of US 62/70 and 1 mile east of CR 211 in Floyd County. The link extends southeast for approximately 1.1 miles to where it crosses CR 231, and then continues approximately 1 mile to where it crosses US 62/70 and CR 241. After crossing US 62/70 and CR 241, it continues approximately 1 mile, and then angles south-southeast for approximately 0.2 mile, where it heads southeast again and begins to run parallel to and on the north side of an abandoned railroad grade. The link then proceeds southeast for approximately 0.8 mile to where it terminates at the junction of Links C1 and EE', located on the northeast side of the abandoned railroad grade, approximately 1 mile south of US 62/70, and 2.8 miles east of FM/RR 602 in Floyd County.

Link EE'

Link EE' begins at the junction of Links C1 and EE, located on the northeast side of an abandoned railroad grade, approximately 1 mile south of US 62/70 and 2.8 miles east of FM/RR 602 in Floyd County. It extends southeast, parallel to and on the north side of an abandoned railroad grade for approximately 1.3 miles, crosses CR 271, then continues another 1.1 miles to CR 283. Link EE' then angles south-southeast as it crosses CR 283 and the abandoned railroad grade. After crossing CR 283 and the abandoned railroad grade, the link then heads south, parallel to and on the east side of CR 283 for approximately 0.3 mile as it crosses an existing 69-kV transmission line and CR 270 and turns to the southeast. Link EE' then proceeds southeast for approximately 1.2 miles, crosses CR 293, extends approximately 0.5 mile, crosses CR 284, and continues approximately 1.3 miles where it crosses an existing 345-kV transmission line. It extends approximately another 0.1 mile then adjusts slightly to the east (but still southeast) for approximately 0.6 mile, where it crosses an existing 69-kV transmission line and FM/RR 28. The link then continues southeast for approximately 0.5 mile, crosses FM/RR 684, and then continues for approximately 0.7 mile to where it terminates at the junction of Links D1, OO, PP, and SS, located on the south side of FM/RR 684, approximately 1 mile east of FM/RR 28 and 0.3 mile west of the Floyd/Motley county line in Floyd County.

Link FF'

Link FF' begins at the junction of Links GG and U', located approximately 0.6 mile north of US 62/70 and 0.7 mile west of FM/RR 28 in Floyd County. It extends southeast for approximately 0.8 mile to where it crosses US 62/70, and then continues for approximately 0.3 mile, crossing CR 303 to where it terminates at the junction of Links B6 and FF'', located on the east side of CR 303, approximately 0.3 mile south of US 62/70 in Floyd County.

Link FF''

Link FF'' begins at the junction of Links B6 and FF', located on the east side of CR 303 approximately 0.3 mile south of US 62/70 in Floyd County. It extends southeast for approximately 0.9 mile to where it terminates at the junction of Links C1 and FF''', located on the north side of CR 260, 0.5 mile east of CR 303 in Floyd County.

Link FF'''

Link FF''' begins at the junction of Links C1 and FF'', located on the north side of CR 260, 0.5 mile east of CR 303 in Floyd County. It extends southeast (crossing CR 258) for approximately 2.1 miles, to where it terminates at the junction of Links NN, OO, and RR, located approximately 0.3 mile west of the Floyd/Motley county line and 1.9 miles south of US 62/70 in Floyd County.

Link GG

Link GG begins at the junction of Links FF' and U', located approximately 0.6 mile north of US 62/70 and 0.7 mile west of FM/RR 28 in Floyd County. It extends east for approximately 0.7 mile (crosses FM/RR 28) and terminates on the east side of FM/RR 28 at the junction of Links B5, B6, and GG', located on the east side of FM/RR 28, approximately 0.6 mile north of US 62/70 in Floyd County.

Link GG'

Link GG' begins at the junction of Links B5, B6, and GG, located on the east side of FM/RR 28, approximately 0.6 mile north of US 62/70 in Floyd County. It extends southeast for approximately 0.8 mile, then adjusts slightly more to the east and extends parallel to and on the north side of US 62/70 for approximately 1.6 miles to where it terminates at the junction of Links NN and QQ, located on the north side of US 62/70, approximately 0.3 mile west of the Floyd/Motley county line in Floyd County.

Link HH

Link HH begins at the junction of Links CC and DD, located on the west side of CR 221, approximately 1 mile west of FM/RR 602 and 2.5 miles south of US 62/70 in Floyd County. It extends south, parallel to and on the west side of CR 221, for approximately 0.5 mile, crosses CR 280 and terminates at the junction of Links II and JJ, located on the southwest side of the intersection of CR 221 and CR 280, approximately 3 miles south of US 62/70 and 1.2 miles west of the intersection of FM/RR 602 and CR 280 in Floyd County.

Link II

Link II begins at the junction of Links HH and JJ, located on the southwest side of the intersection of CR 221 and CR 280, approximately 3 miles south of US 62/70 and 1.2 miles west of the intersection of FM/RR 602 and CR 280 in Floyd County. The link extends south, parallel to and on the west side of CR 221, for approximately 1 mile where it crosses an existing 345-kV transmission line and CR 290. It then continues south approximately 2 miles where it crosses CR 310. It then continues south, still parallel to and on the west side of CR 221, for approximately 1 mile, crosses FM/RR 1958, and then turns to the east. The link then heads east, parallel to and on the south side of FM/RR 1958, for approximately 0.8 mile, crosses CR 231 and then turns south. It then heads south, parallel to and on the east side of CR 231 for approximately 2 miles to the north side of CR 342. The link then turns east as it extends parallel to and on the north side of CR 342 for approximately 0.4 mile, then angles east-southeast and crosses to the south side of CR 342. After crossing CR 342, Link II heads east, parallel to and on the south side of CR 342, for approximately 1.4 miles, crosses CR 342 and CR 251 (north of the intersection of CR 342 and CR 251), and extends for approximately 0.2 mile before crossing CR 342 again. It then extends approximately 0.5 mile and crosses CR 259. It continues east approximately 2 miles, crosses CR 279, proceeds approximately 0.8 mile, and then terminates at the junction of Links JJ, KK, and LL, located approximately 1.5 miles south of FM/RR 1958, 2.3 miles west of FM/RR 28, and 0.9 mile north of the Floyd/Crosby county line in Floyd County.

Link JJ

Link JJ begins at the junction of Links HH and II, located on the southwest side of the intersection of CR 221 and CR 280, approximately 3 miles south of US 62/70 and 1.2 miles west of the intersection of FM/RR 602 and CR 280 in Floyd County. It crosses CR 221 as it extends southeast for approximately 1.3 miles, before crossing an existing 345-kV transmission line and CR 290. It then continues 1.4 miles before crossing CR 300 and FM/RR 602. It then extends southeast approximately 1.5 miles, crosses CR 310, and then continues 1.4 miles to where it crosses FM/RR 1958. The link then proceeds southeast approximately 0.7 mile to where it nears, but does not cross, FM/RR 1958 where FM/RR 1958 turns back to the east. The link continues southeast for approximately 1 mile, crosses to the east side of CR 279, where it turns south and extends parallel to and on the east side of CR 279 for approximately 0.4 mile. It then diverts from CR 279 and heads south-southeast for approximately 0.9 mile to where it terminates at the junction of Links II, KK and LL, located approximately 1.5 miles south of FM/RR 1958, 2.3 miles west of FM/RR 28, and 0.9 mile north of the Floyd/Crosby county line in Floyd County.

Link KK

Link KK begins at the junction of Links II, JJ, and LL, located approximately 1.5 miles south of FM/RR 1958, 2.3 miles west of FM/RR 28, and 0.9 mile north of the Floyd/Crosby county line in Floyd County. It extends east for approximately 1.2 miles to the west side of CR 299, then makes a 90-degree turn and heads south, parallel to and on the west side of CR 299, for approximately 0.7 mile to where it terminates at the junction of Links LL and MM, located on the northwest side of the intersection of CR 299 and CR 348, approximately 1.1 miles west of FM/RR 28, and 0.3 mile north of the Floyd/Crosby county line in Floyd County.

Link LL

Link LL begins at the junction of Links II, JJ, and KK, located approximately 1.5 miles south of FM/RR 1958, 2.3 miles west of FM/RR 28, and 0.9 mile north of the Floyd/Crosby county line in Floyd County. It extends southeast for approximately 1.4 miles to where it terminates at the junction of Links KK and MM, located on the northwest side of the intersection of CR 299 and CR 348, approximately 1.1 miles west of FM/RR 28, and 0.3 mile north of the Floyd/Crosby county line in Floyd County.

Link MM

Link MM begins at the junction of Links LL and KK, located on the northwest side of the intersection of CR 299 and CR 348, approximately 1.1 miles west of FM/RR 28, and 0.3 mile north of the Floyd/Crosby county line, in Floyd County. The link crosses CR 299 and heads east parallel to and on the north side of CR 348 for approximately 1 mile before crossing an existing 69-kV transmission line and FM/RR 28. CR 348 then ends and the link no longer parallels CR 348. The link then continues east for approximately 1.2 miles to where it terminates at the junction of Links MM1, PP, and TT, located approximately 1.2 miles east of FM/RR 28, 0.4 mile west of the Floyd/Motley county line, and 0.2 mile north of the Floyd/Crosby county line in Floyd County.

Link MM1

Link MM1 begins at the junction of Links MM, PP, and TT, located approximately 1.2 miles east of FM/RR 28, 0.4 mile west of the Floyd/Motley county line, and 0.2 mile north of the Floyd/Crosby county line in Floyd County. It extends east for approximately 0.4 mile to the Floyd/Motley County Line, then continues east for approximately 1 mile in Motley County, then angles slightly to the east-northeast for approximately 2.6 miles, to where it terminates at the junction of Links MM2, SS, and SS', located approximately 0.3 mile north of the Motley/Dickens county line, and 3.7 miles east of the Floyd/Motley county line in Motley County.

Link MM2

Link MM2 begins at the junction of Links MM1, SS, and SS', located approximately 0.3 mile north of the Motley/Dickens county line, and 3.7 miles east of the Floyd/Motley county line in Motley County. The link extends east approximately 2.4 miles to where it terminates at the junction of Links MM3, RR', and RR'', located approximately 0.5 mile north of the Motley/Dickens county line, and 5.1 miles west of SH 70 in Motley County.

Link MM3

Link MM3 begins at the junction of Links MM2, RR' and RR'', located approximately 0.5 mile north of the Motley/Dickens county line and 5.1 miles west of SH 70, in Motley County. It extends east for approximately 1.1 miles to where it terminates at the junction of Links D4, D5, and MM4, located approximately 0.5 mile north of the Motley/Dickens county line and 4 miles west of SH 70 in Motley County.

Link MM4

Link MM4 begins at the junction of Links D4, D5, and MM3, located approximately 0.5 mile north of the Motley/Dickens county line and 4 miles west of SH 70, in Motley County. It extends east-southeast for approximately 2 miles as it crosses the Tongue River (twice) to where it terminates at the junction of Links QQ'' and QQ''', located approximately 0.1 mile north of the Motley/Dickens county line and 2 miles west of SH 70 in Motley County.

Link NN

Link NN begins at the junction of Links GG' and QQ, located on the north side of US 62/70, approximately 0.3 mile west of the Floyd/Motley county line, in Floyd County. It immediately crosses US 62/70 and extends south for approximately 1.9 miles to where it terminates at the junction of Links FF''', OO, and RR, located approximately 0.3 mile west of the Floyd/Motley county line and 1.9 miles south of US 62/70 in Floyd County.

Link OO

Link OO begins at the junction of Links FF''', NN, and RR, located approximately 0.3 mile west of the Floyd/Motley county line and 1.9 miles south of US 62/70 in Floyd County. It extends south for approximately 0.7 mile, crosses an abandoned railroad grade and continues approximately 0.9 mile before crossing an existing 345-kV transmission line. It then continues south for approximately 0.9 mile where it crosses FM/RR 684 and terminates at the junction of Links D1, EE' and PP, located on the south side of FM/RR 684, approximately 1 mile east of FM/RR 28 and 0.3 mile west of the Floyd/Motley county line in Floyd County.

Link PP

Link PP begins at the junction of Links D1, EE', OO, and SS, located on the south side of FM/RR 684 approximately 1 mile east of FM/RR 28 and 0.3 mile west of the Floyd/Motley county line, in Floyd County. It extends south for approximately 0.8 mile, angles very slightly to the southwest for approximately 0.5 mile, and then continues south again for approximately 3.4 miles where it terminates at the junction of Links

MM, MM1, and TT, located approximately 1.2 miles east of FM/RR 28, 0.4 mile west of the Floyd/Motley county line, and 0.2 mile north of the Floyd/Crosby county line in Floyd County.

Link QQ

Link QQ begins at the junction of Links GG' and NN, located on the north side of US 62/70, approximately 0.3 mile west of the Floyd/Motley county line in Floyd County. It crosses US 62/70 and extends southeast for approximately 0.5 mile where it crosses into Motley County. It continues southeast for approximately 4.4 miles, crossing Spring Creek and an existing 345-kV transmission line. It then continues southeast for approximately 1.6 miles to where it crosses FM/RR 684, and then continues for approximately 1.9 miles to where it terminates at the junction of Links D2, D3, and QQ', located on the northeast side of an abandoned railroad grade, approximately 1.3 miles south of FM/RR 684 and 1.5 miles west of CR 316 in Motley County.

Link QQ'

Link QQ' begins at the junction of Links D2, D3, and QQ, located on the northeast side of an abandoned railroad grade, approximately 1.3 miles south of FM/RR 684 and 1.5 miles west of CR 316 in Motley County. It crosses the abandoned railroad grade and extends southeast for approximately 2.6 miles to where it terminates at the junction of Links D3, D4, and QQ'', located approximately 3.7 miles west of SH 70 and 1.5 miles north of the Motley/Dickens county line in Motley County.

Link QQ''

Link QQ'' begins at the junction of Links D3, D4, and QQ', located approximately 3.7 miles west of SH 70 and 1.5 miles north of the Motley/Dickens county line in Motley County. It extends southeast for approximately 2.5 miles as it crosses the Tongue River, to where it terminates at the junction of Links MM4 and QQ''', located approximately 0.1 mile north of the Motley/Dickens county line and 2 miles west of SH 70 in Motley County.

Link QQ'''

Link QQ''' begins at the junction of Links MM4 and QQ'', located approximately 0.1 mile north of the Motley/Dickens county line and 2 miles west of SH 70 in Motley County. The link extends south approximately 0.1 mile, crosses the Motley/Dickens county line into Dickens County, proceeds south for approximately 1.7 miles, where it begins to extend parallel to and on the west side of CR 127, and continues parallel to and on the west side of CR 127 for approximately 1 mile before crossing CR 110. It proceeds south approximately 0.9 mile, and then heads south-southeast as it crosses to the east side of CR 127 and continues approximately 0.1 mile where it enters the northwest side of the proposed Cottonwood Station, located approximately 0.5 mile north of FM/RR 193 and 1.5 miles west of SH 70 in Motley County.

Link RR

Link RR begins at the junction of Links FF'', NN, and OO, located approximately 0.3 mile west of the Floyd/Motley county line and 1.9 miles south of US 62/70 in Floyd County. It extends southeast for approximately 0.5 mile, crosses into Motley County, and continues for approximately 0.8 mile, where it adjusts slightly to the east and parallels an abandoned railroad grade for approximately 0.8 mile. The link then crosses an existing 345-kV transmission line and the abandoned railroad grade, and then angles slightly to the south for approximately 1.6 miles, as it crosses FM/RR 684 to where it terminates at the junction of Links D1, D2, and RR', located on the south side of FM/RR 684, approximately 2.2 miles east of the Floyd/Motley county line in Motley County.

Link RR'

Link RR' begins at the junction of Links D1, D2, and RR, located on the south side of FM/RR 684 in Motley County, approximately 2.2 miles east of the Floyd/Motley county line. The link extends southeast for approximately 3.1 miles before it adjusts to the south-southeast for approximately 0.5 mile, and then back to the southeast for approximately 1.5 miles. It then again turns more to the south for approximately 1.3 miles to where it terminates at the junction of Links MM2, MM3, and RR'', located approximately 0.5 mile north of the Motley/Dickens county line, and 5.1 miles west of SH 70 in Motley County.

Link RR''

Link RR'' begins at the junction of Links MM2, MM3, and RR', located approximately 0.5 mile north of the Motley/Dickens county line, and 5.1 miles west of SH 70 in Motley County. It extends southeast for approximately 2 miles as it crosses into Dickens County and crosses Grapevine Creek, to where it terminates at the junction of Links D5, D6, and RR''', located approximately 3.5 miles north of FM/RR 193, and 4 miles west of SH 70 in Dickens County.

Link RR'''

Link RR''' begins at the junction of Links D5, D6, and RR'', located approximately 3.5 miles north of FM/RR 193, and 4 miles west of SH 70 in Dickens County. It extends southeast for approximately 3.2 miles as it crosses CR 110 and CR 127, to where it terminates at the northwest corner of the proposed Cottonwood Station, located approximately 0.5 mile north of FM/RR 193 and 1.5 miles west of SH 70 in Dickens County.

Link SS

Link SS begins at the junction of Links D1, EE', OO, and PP, located on the south side of FM/RR 684, approximately 1 mile east of FM/RR 28 and 0.3 mile west of the Floyd/Motley county line in Floyd County. It extends southeast for approximately 0.5 mile, crosses into Motley County, and continues for approximately 5.8 miles, crossing Wolf Creek and terminating at the junction of Links MM1, MM2, and SS', located approximately 0.3 mile north of the Motley/Dickens county line, and 3.7 miles east of the Floyd/Motley county line in Motley County.

Link SS'

Link SS' begins at the junction of Links MM1, MM2, and SS, located approximately 0.3 mile north of the Motley/Dickens county line, and 3.7 miles east of the Floyd/Motley county line in Motley County. The link extends southeast approximately 0.5 mile, crosses the Motley/Dickens county line into Dickens County, then extends approximately 0.1 mile before crossing Rustler Creek. It proceeds southeast for approximately 2.7 miles before crossing Grapevine Creek, then continues approximately another 2.1 miles to where it terminates at the junction of Links D6, D7, and SS'', located approximately 0.5 mile west of CR 121 and 1 mile north of FM/RR 193 in Dickens County.

Link SS''

Link SS'' begins at the junction of Links D6, D7, and SS', located approximately 0.5 mile west of CR 121 and 1 mile north of FM/RR 193 in Dickens County. It extends east for approximately 0.5 mile, crosses CR 121, and then continues east parallel to and on the south side of CR 112 for approximately 1.5 miles to where it crosses CR 127 and enters the northwest corner of the proposed Cottonwood Station, located approximately 0.5 mile north of FM/RR 193 and 1.5 miles west of SH 70 in Dickens County.

Link TT

Link TT begins at the junction of Links MM, MM1, and PP, located approximately 1.2 miles east of FM/RR 28, 0.4 mile west of the Floyd/Motley county line, and 0.2 mile north of the Floyd/Crosby county line, in Floyd County. It extends southeast for approximately 0.5 mile, crosses over the point where Floyd, Motley, Crosby, and Dickens counties all meet, and continues for approximately 3.8 miles, crossing over Rustler Creek. It then continues southeast for approximately 4.5 miles, crossing Grapevine Creek, to where it terminates at the junction of Links D7 and TT', located approximately 0.5 mile north of FM/RR 193 and 0.5 mile west of CR 121 in Dickens County.

Link TT'

Link TT' begins at the junction of Links D7 and TT, located approximately 0.5 mile north of FM/RR 193 and 0.5 mile west of CR 121 in Dickens County. The link extends east for approximately 0.5 mile, crosses CR 121, and then extends approximately another 1.5 miles before crossing CR 127 as it enters the southwest corner of the proposed Cottonwood Station, located approximately 0.5 mile north of FM/RR 193 and 1.5 miles west of SH 70 in Dickens County.

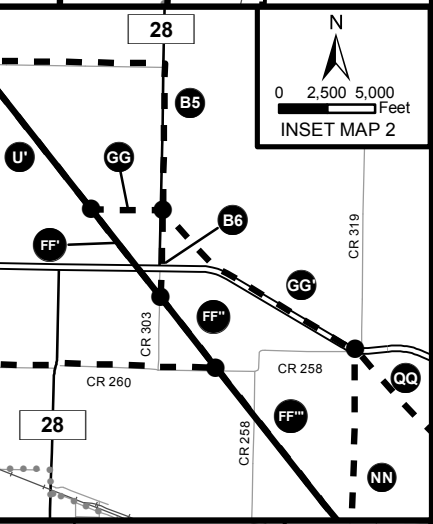
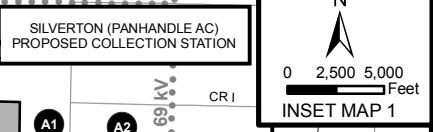
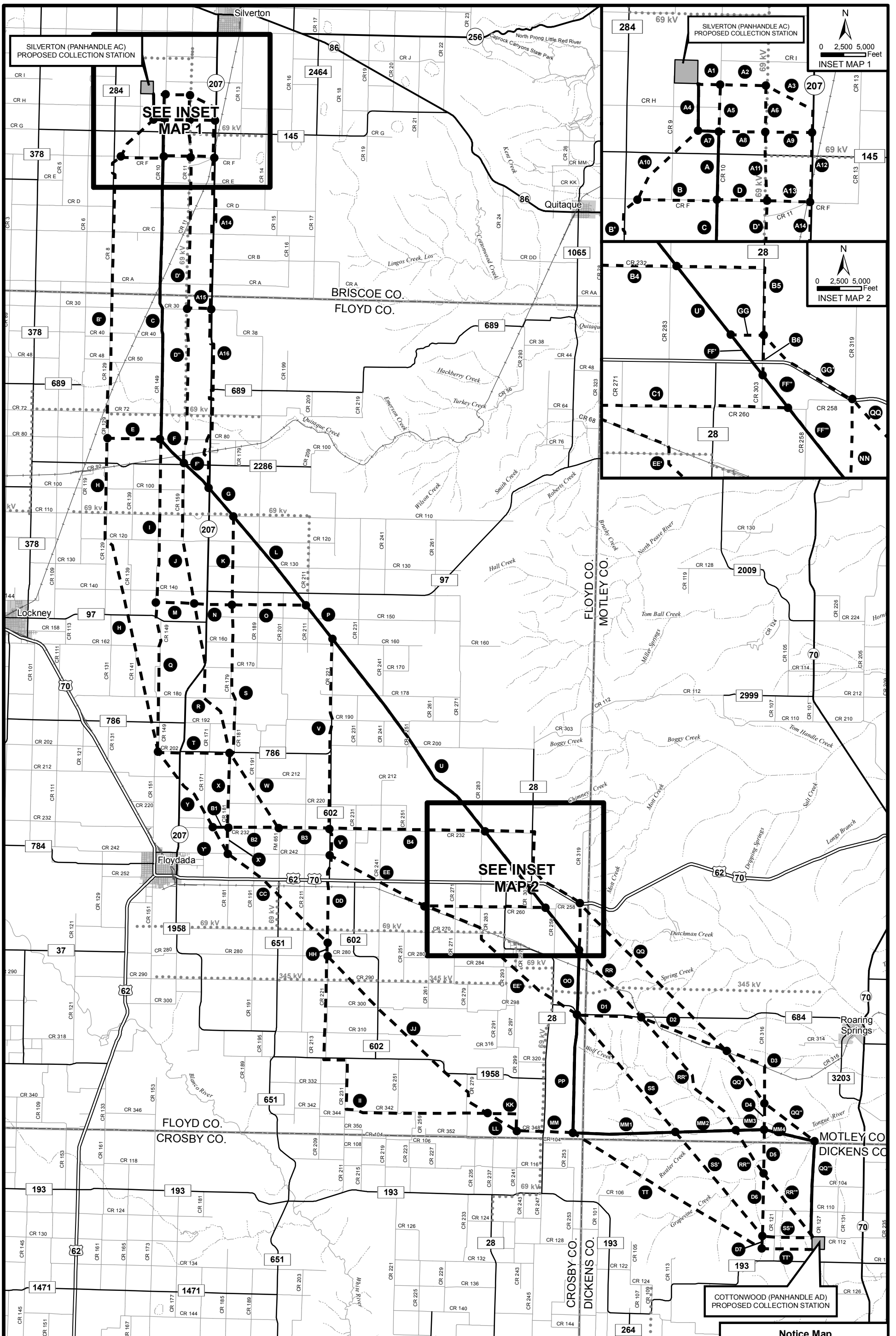

PBSJ
 • Engineering
 • Environmental Consulting
 • Surveying

- Link Designation
- Link Intersection
- Alternative Link
- Preferred Route
- Existing Xcel Energy / SPS Transmission Line
- Abandoned Railroad Grade

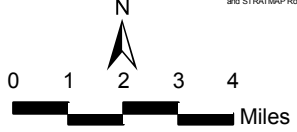

Notice Map
Silverton (Panhandle AC)
To Cottonwood (Panhandle AD)
345-kV CREZ Transmission Line



Base Map: TXDOT County Urban and STRATMAP Road Files